

The data sheets, which, with their technical drawings, are the property of the manufacturer. They are to be used only for the purpose for which they were intended. Any other use, reproduction, distribution, or disclosure of any other person's data is prohibited. The manufacturer is not responsible for any damage or loss of data caused by the use of these data sheets. The manufacturer is not responsible for any damage or loss of data caused by the use of these data sheets. The manufacturer is not responsible for any damage or loss of data caused by the use of these data sheets.

- STN
 - TH
 - TG
 - Niv. min. in KI
 - Niv. min. in KI
 - Niv. min. in KI
- | M1 | M2 | M3 | M4 | M5 | M6 | M7 | M9 | M10 | M11 | M12 |
|------------------------|----------------------|----------------------|----------------------|----------------------|--------------------------|------------------|-------------------------|---------------------|-----------------------|-------------------------|
| TR3-VS Einlauf (Input) | AZ95 Einlauf (Input) | MS12 Einlauf (Input) | MS12 Einlauf (Input) | MS12 Einlauf (Input) | TRK3 Kontrolle (Control) | STW-ZBF Strip | MT1 Nachschaben (Strip) | KSK Kaskade (Strip) | TRK2 Tranchen (Strip) | TR2-VS Auslauf (Output) |
| Intermittierend | Intermittierend | Intermittierend | Intermittierend | Intermittierend | Intermittierend | Intermittierend | Intermittierend | Intermittierend | Intermittierend | Intermittierend |
| Intermitt. spray | Intermitt. spray | Intermitt. spray | Intermitt. spray | Intermitt. spray | Intermitt. spray | Intermitt. spray | Intermitt. spray | Intermitt. spray | Intermitt. spray | Intermitt. spray |

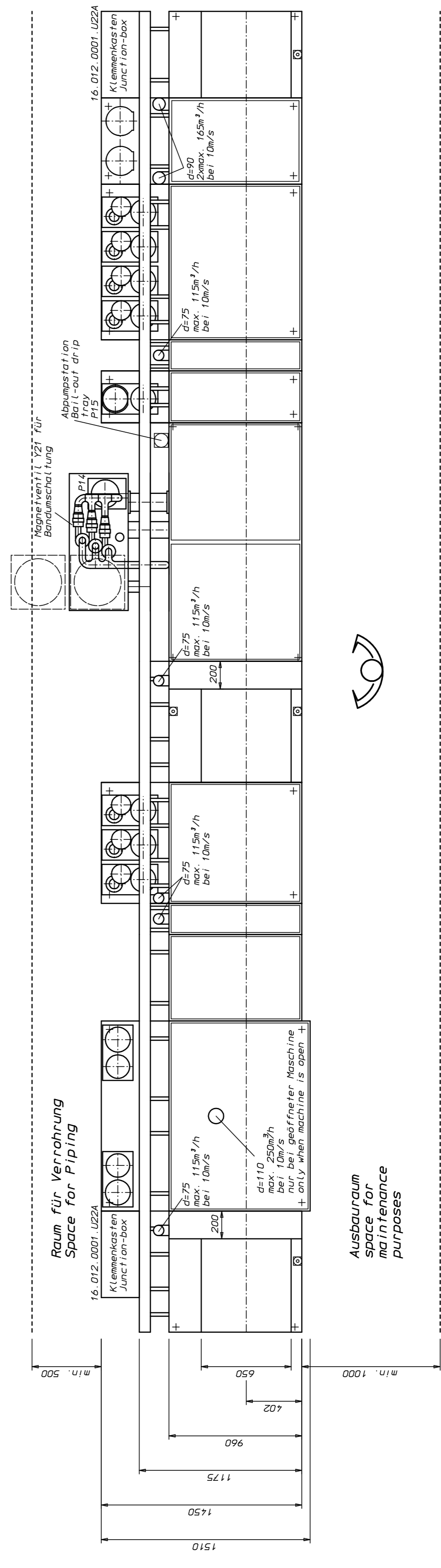
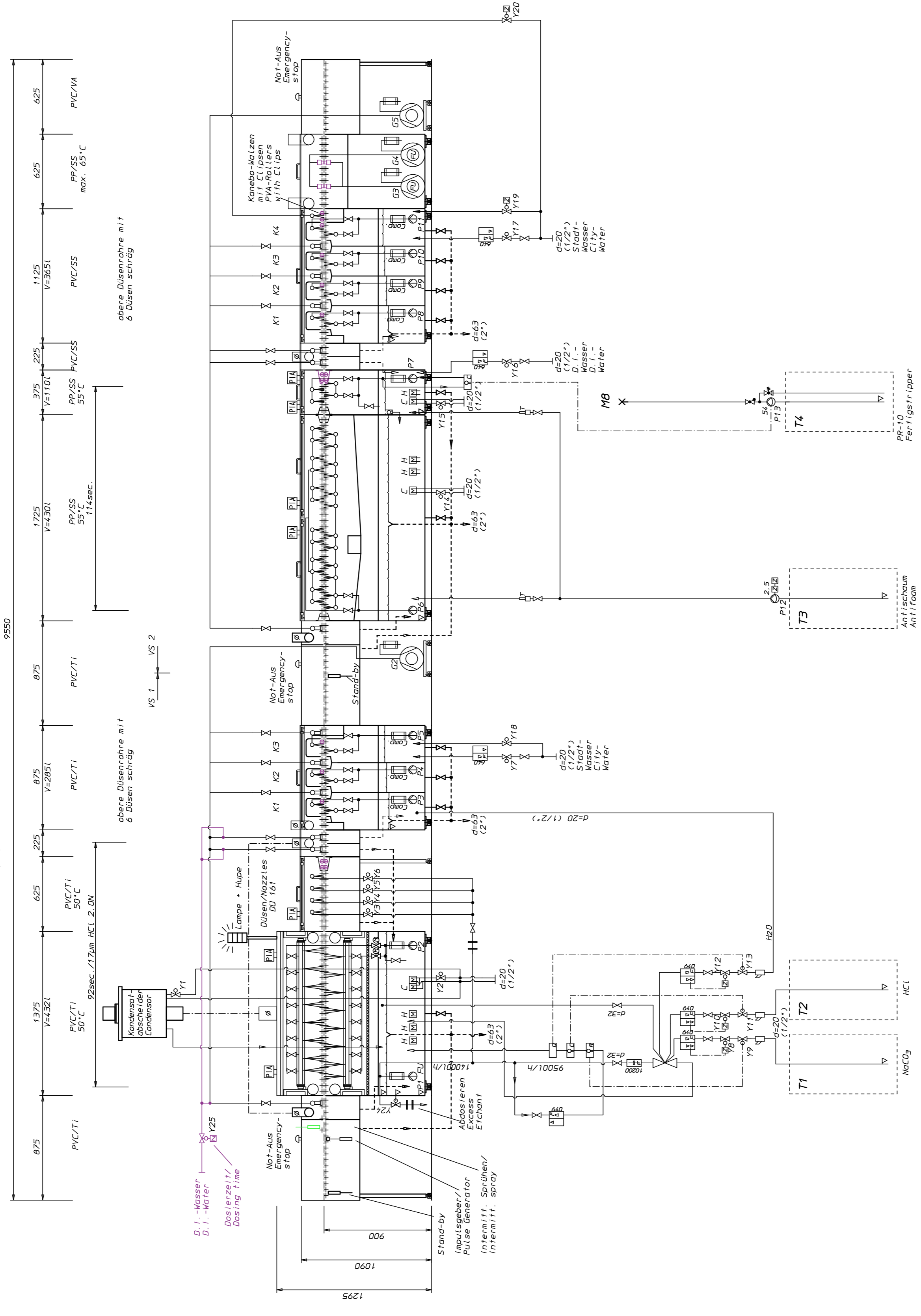

Pumpenliste / List of pumps

P6 03.025.0006.0130 4,8kW
 P1 P2 PUTA0153-000400 4,8kW
 P3-P5 PUTA015300-00871 0,44kW

Pumpenliste / List of pumps

P6 03.025.0006.0130 4,8kW
 P1 P2 PUTA0153-000400 4,8kW
 P3-P5 PUTA015300-00871 0,44kW

Achtung!
 Die Leiterteile im Stripper müssen aus V4A sein.
 Bitte prüfen!

USA ca. 1,0m/min
 Conveyor speed approx. 1,0m/min
 Ultraflex-Transport, Transportrollen oben auf 1,5m Distanz eingebaut
 Arbeitssbreite/Working Width max.: 650mm
 Plattenform/Panel Size min.: 12"
 Plattendicke/Panel Thickness max.: 2,0mm
 min.: 2,0mm

Com.-No.: 91-03-213
 99-03-324
 99-03-324
 99-03-328
 99-03-399
 99-03-537
 99-04-301
 99-04-302

2024	Date	Name	File
2024	26.06.2024	10712	1560513
2024	26.06.2024	10712	1560513
2024	26.06.2024	10712	1560513

21-15605-13-A1
ES-Line